

## SES Login Guide V1.2

根据联想的安全要求，SES 系统的登录界面需要升级，请根据您的账号情况，选择使用 ITcode（联想用户）或 Lenovo ID（非联想用户）进行系统的认证和登录。

According to the Lenovo's security requirements, SES's login interface needs to be upgraded please select the ITcode (Lenovo User) or Lenovo ID (non-Lenovo User) for certification and login based on your account status.

➤ **如果你是新用户，请先申请 SES 新账号**

**If you are a new user, please first apply for a new SES account.**

如果你是 SES 新用户，请先在登录界面选择 Register，按要求填写相关信息去申请新账户。申请成功后，按以下步骤完成 ITcode（联想用户）或 Lenovo ID（非联想用户）认证。

If you are a new user, please select "Register" and fill in the related required information to apply for a new account. After the application is successful, then follow the steps below to complete the ITcode (Lenovo User) or Lenovo ID (non-Lenovo User) certification.

**注意：**对于联想用户，必须使用与 ITcode 一样的账号，否则无法通 ITcode (ADFS) 认证，如果你的账号不是 ITcode，请重新申请新账户。非联想用户没有此账号要求。

**Note:** For Lenovo users, you must use the same account as your ITcode, otherwise, you will not be able to pass the ITcode (ADFS) certification. If your account is not an ITcode, please apply for a new account. Non-Lenovo users do not have this account requirement.



➤ **如果你已经有 SES 账号，请按以下步骤完成 ITcode（联想用户）或 Lenovo ID（非联想用户）的系统认证，以免影响你后续系统的正常登录。Password 登录方式很快会停用。**

**If you have an SES account, please follow the steps below to complete the ITcode (for Lenovo User) or Lenovo ID (non-Lenovo User) certification, to avoid affecting the SES normal login in the future. The password login method will be discontinued soon.**

## 1. 对于 Lenovo 用户，如何完成 ITcode (ADFS) 认证?

### For Lenovo User, how to complete the ITcode (ADFS) certification?

在登录界面选择 ITcode，点击 Login。如果你是首次登录，将进入认证界面，输入 ITcode 和 ITcode 密码，认证成功后，你将直接进入 SES 系统。第二次登录系统，无需再认证，选择 ITcode 和 Login 后可直接进入 SES 系统。

In the login interface to select the "ITcode" button, then click "Login". If this is your first login, you will enter the certification interface, then enter your "ITcode" and "ITcode password". After successful certification, you will enter the SES system. For the second login, no further certification is required, just select "ITcode" and "Login" to directly enter the SES system.

注意：对于联想用户，必须使用与 ITcode 一样的账号，否则无法通过 ITcode (ADFS) 认证，如果你的账号不是 ITcode，请重新申请新账户。非联想用户没有此账号要求。

Note: For Lenovo users, you must use the same account as your ITcode, otherwise, you will not be able to pass the ITcode (ADFS) certification. If your account is not an ITcode, please apply for a new account. Non-Lenovo users do not have this account requirement.

The image displays two screenshots of the Lenovo Service Engineering Support (SES) login interface. The top screenshot is the English version, showing the 'Lenovo ID', 'ITcode', and 'Password' fields. The 'ITcode' field is highlighted with a red box. Below the fields is a blue circle labeled 'ADFS Certification' and a blue button labeled 'Login', both also highlighted with red boxes. There are links for 'Register' and 'Login Guide' below the 'Login' button. The bottom screenshot is the Chinese version, showing the '登录' (Login) page with the URL 'https://stscn.lenovo.com'. It features input fields for '用户名' (Username) and '密码' (Password), both highlighted with red boxes. There are buttons for '登录' (Login) and '取消' (Cancel) at the bottom.

## 2. 对于非 Lenovo 用户，如何完成 Lenovo ID 认证？

### For non-Lenovo User, how to complete the Lenovo ID certification?

选择 Lenovo ID，点击 Activate Lenovo ID”。如果你是首次登录，将进入认证界面，然后需要输入邮箱（注意该邮箱将会被注册为 Lenovo ID 并用于后续的系统登录，因此需要保证真实和有效，该邮箱可与账号注册时的邮箱一致或不同）。如果 Lenovo ID 激活成功，则可以使用该邮箱进行系统登录；如果激活失败，请按系统页面提示进一步操作，直到激活成功。

Select the "Lenovo ID", then click "Activate Lenovo ID". If this is your first login, you will enter the certification interface, then you need to enter your email address (Note that this email address will be registered as your Lenovo ID and will be used for subsequent system login. So, it is necessary to ensure its true and valid). The email address can be the same as or different from the one used for account registration. If the Lenovo ID activation is successful, you can use this email address for system login; If the activation fails, please follow the prompts on the system page to take further actions until the activation is successful.

1) 选择 Lenovo ID，点击 Activate Lenovo ID。

Select the "Lenovo ID", then click "Login".



2) 输入账号的用户名和密码。

Enter your account and password.



3) 输入邮箱，然后单击 Activate，激活成功后，单击 close 关闭窗口。

(注意：该邮箱将会被注册为 Lenovo ID 并用于后续的系统登录，因此需要保证真实和有效，该邮箱可与账号注册时的邮箱一致或不同)。

Enter your email address, then click "Activate". After the Activation Successful, click "close" to close the interface. (Note that this email address will be registered as your Lenovo ID and will be used for subsequent system login. So, it is necessary to ensure its true and valid).

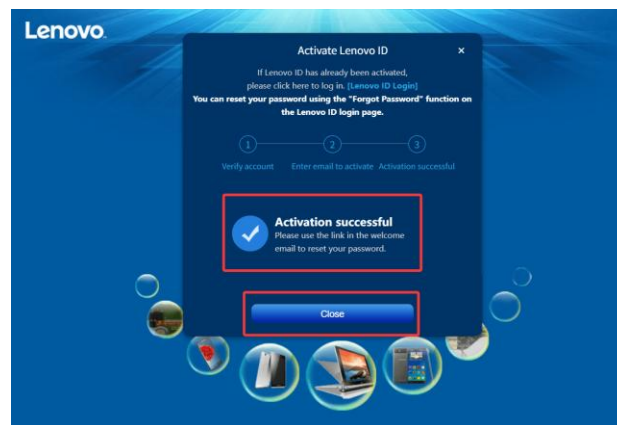
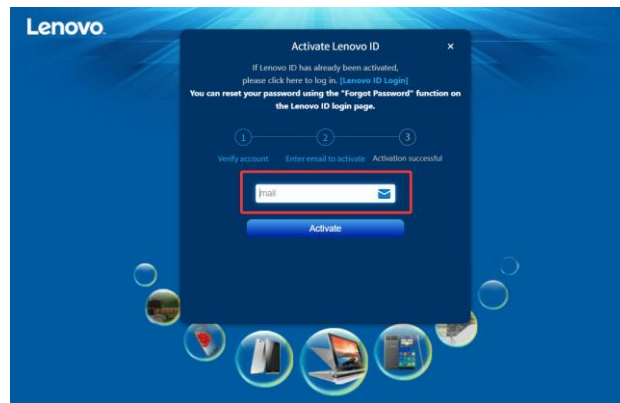

4) 在登录界面，选择 Lenovo ID 和 Login，然后输入前面注册的邮箱和地址。

On the login interface, select "Lenovo ID" and "Login", then enter the email and password that you registered previously.





5) 前面注册的邮箱将收到一封来自 SES 系统的邮件，点击邮件里的链接，按系统要求输入并更新密码。

The email you registered for earlier will receive a message from SES system. Click on the link in the message and follow the system's instructions to enter and update your password.

**Notification of successful activation of LenovoID** ☆

ses\_mbg1 <ses\_mbg1@sina.com> 2025年11月21日 09:44 更多操作  
收件人 我 <1549617337@qq.com> 详细信息

📧 邮件内容可能涉及财产、账号安全，请谨慎对待。

🌐 邮件可翻译为中文 全文翻译

Dear user,

Your LenovoID has been activated. Please use this link [https://sdcso.lenovo.com/webauthn/credential/init?init\\_code=0ZizCp%2BDTd3CYCAgNltrzQ%3D%3D&init\\_username=9zVHraLlPy1pCBs53DyBOGGJQfnDBrgxToUwANHTE%3D&webauthn\\_action=uiologin&webauthn\\_realm=ses.lenovo.com&webauthn\\_callback=https://ses.lenovo.com&webauthn\\_state=null&webauthn\\_lang=en\\_US&account\\_type=new](https://sdcso.lenovo.com/webauthn/credential/init?init_code=0ZizCp%2BDTd3CYCAgNltrzQ%3D%3D&init_username=9zVHraLlPy1pCBs53DyBOGGJQfnDBrgxToUwANHTE%3D&webauthn_action=uiologin&webauthn_realm=ses.lenovo.com&webauthn_callback=https://ses.lenovo.com&webauthn_state=null&webauthn_lang=en_US&account_type=new) to reset your password and log in.

Thanks.

## Reset your password

Set password

Password must include:

- 8-20 characters
- Upper or lower case letters
- Numbers
- Special characters. (!, \$, %, ...)

Confirm password

Next

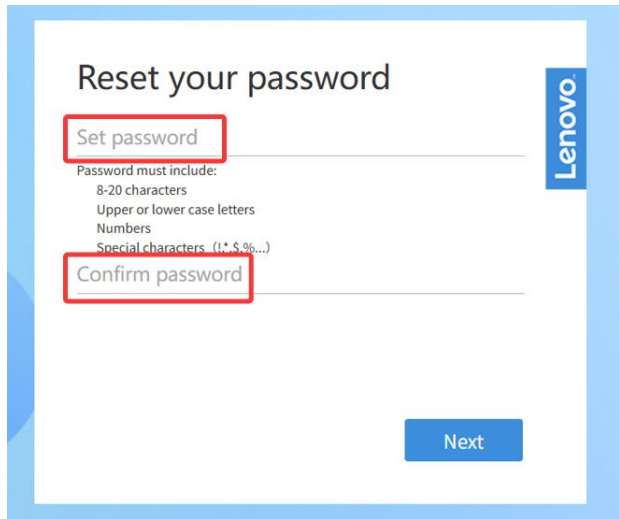

## Your password is changed

All Done!

Click 'Next' to continue.

Next

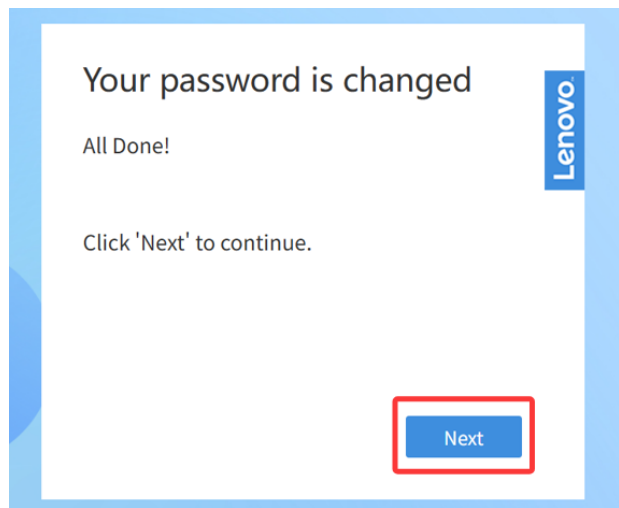

### Update password

Better protect your account with a stronger password.

Old password

Please enter a password

New password

Reset your password

Confirm password

Passwords must have at least 8-20 english characters and contain at least three of the following: uppercase letters, lowercase letters, numbers, and symbols.

Back

Change

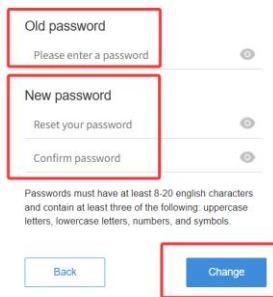

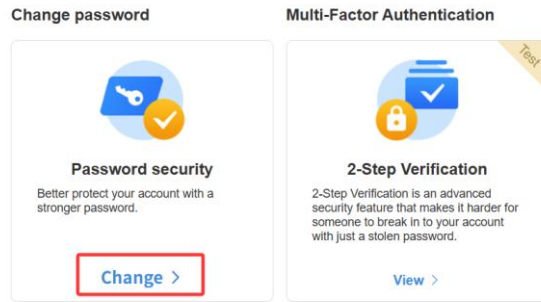

6) 密码更新完成，回到登录界面，选择 Lenovo ID 和 Login，输入前面注册邮箱和新密码。  
 The password update is complete, return to the login interface, select "Lenovo ID" and "Login", then enter the previously registered email address and new password.

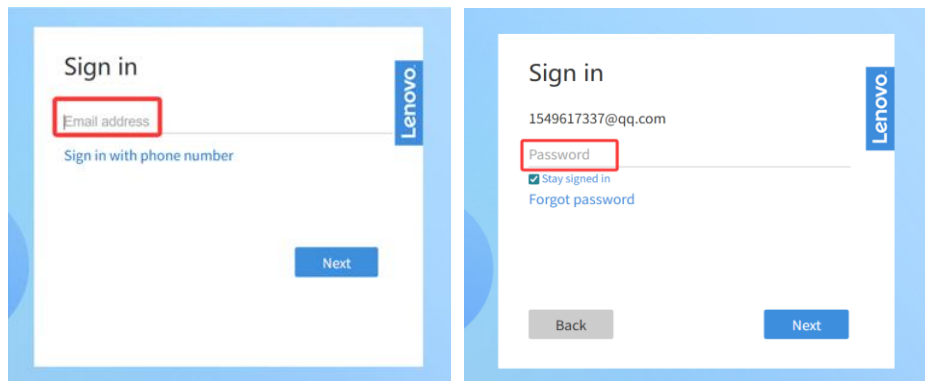

7) 你将收到一封来自 Lenovo Partner 的邮件，打开邮件，找到其中的 6 位验证码，并输出到系统，完成最终的 Lenovo ID 认证。  
 You will receive an email from Lenovo Partner. Open the email, find the six-digit verification code, and input it into the system to complete the final Lenovo ID verification.

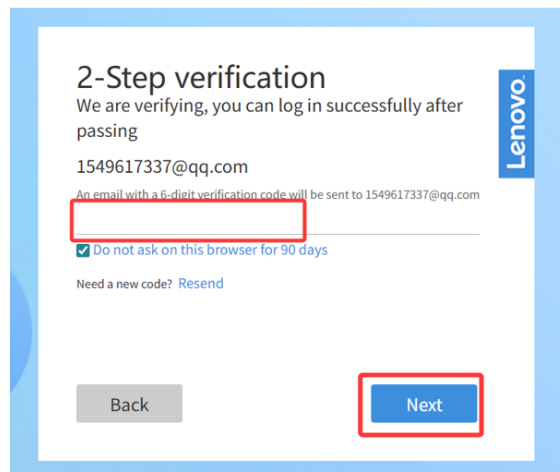
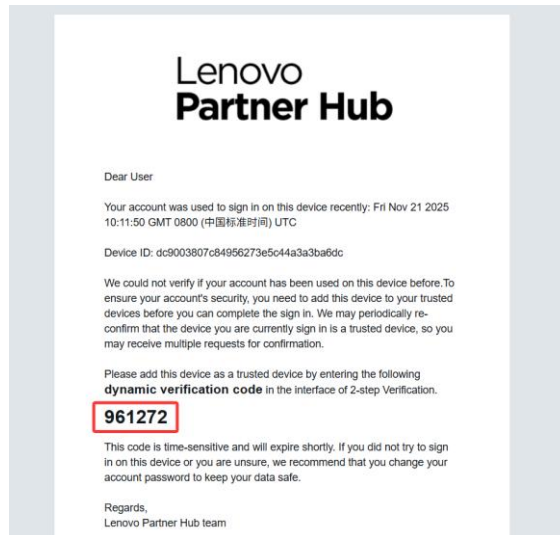

8) 以上所有步骤都完成和通过，回到登录界面，选择 Lenovo ID 和 Login 即可正常登录 SES 系统。

Once all the above steps have been completed and passed, return to the login interface, select "Lenovo ID" and "Login", you can login to the SES system normally.

